

# INTERIOR DESIGN®

OCTOBER  
2024

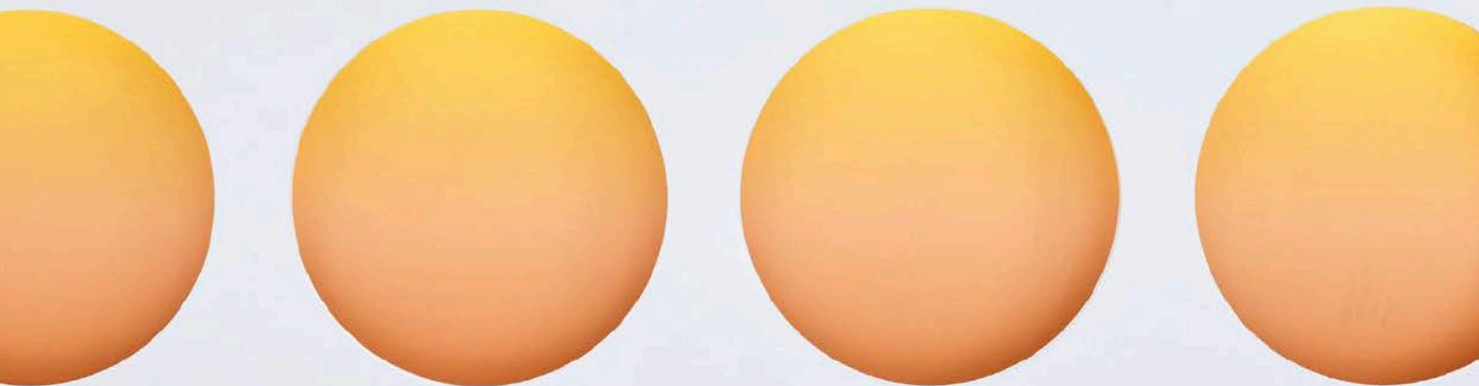

*hip for hospitality*





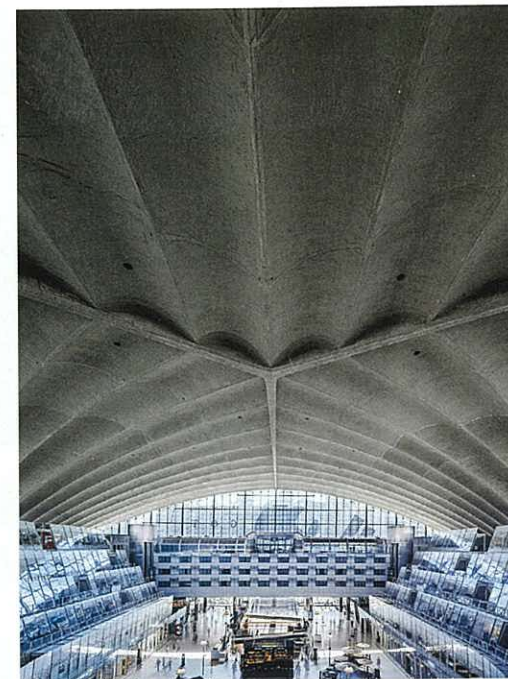
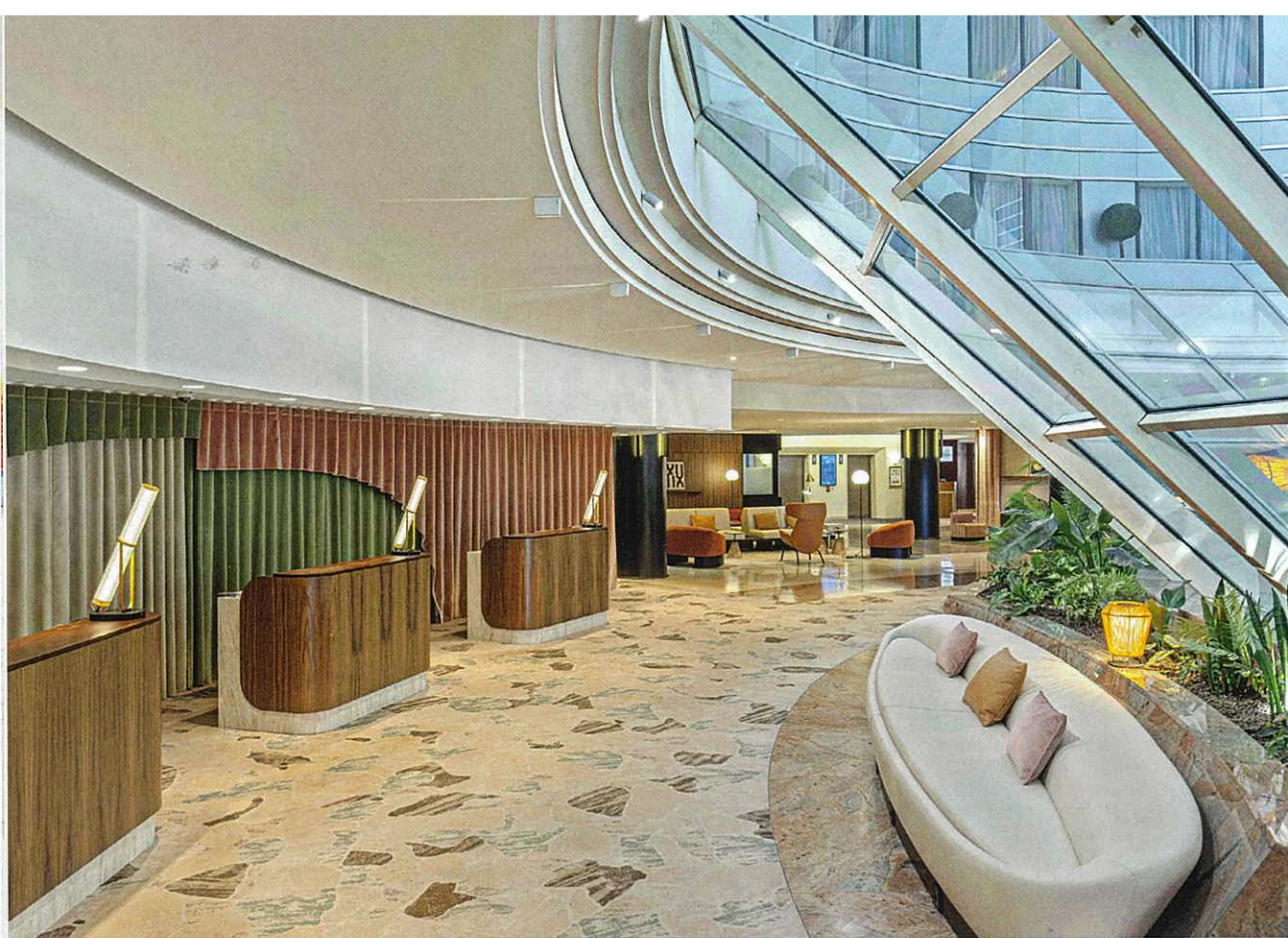

WALKthrough hotels



## Saguez & Partners

**project** Hilton Paris La Défense.

**keys** 153.

**standout** The studio's first project for the mega brand is housed inside the Center for New Technologies & Industries, built in 1958 by architects Robert Camelot, Jean de Mailly, and Bernard Zehruss (with Jean Prouvé contributing to the exterior) in what's now Europe's largest business district. But since work and play constantly intermingle post-COVID, public spaces, which have maintained such original elements as the 150-foot-tall concrete vault and reception's stone flooring, and guest rooms have been imbued with "French 1960's glamour." Custom furniture in the lobby, lounge, and Muses restaurant is informed by that by Pierre Paulin and Charlotte Perriand from that era, while Berit Mogensen Lopez's artworks, the eatery's bold vinyl mural, and guest-room corridor carpet by Alarwool boast rhythmic patterns and engaging colors. [saguez-and-partners.com](http://saguez-and-partners.com) ➤

